



Fans W2E143-AA09-93

URL:<https://www.sxplc.com/fans-w2e143-aa09-93>

Product data sheet

Motor	M2E052-BF		
Phase	1~	1~	1~
Nominal voltage / VAC	230	230	230
Frequency / Hz	50	60	60
Method of obtaining data	fa	fa	fa
Valid for approval/ standard	CE	CE	UL 507
Speed (rpm) / min⁻¹	2800	3300	3300
Power consumption / W	24	26	28
Current draw / A	0.12	0.11	
Capacitor / μF	0.75	0.75	0.75
Capacitor voltage / VDB	400	400	400
Capacitor standard	S0 (CE)	S0 (CE)	UL
Min. ambient temperature / °C	-25	-25	-25
Max. ambient temperature / °C	70	70	70
Starting current / A	0.26	0.26	0.26

ml = Max. load - me = Max. efficiency - fa = Free air
cs = Customer specification - ce = Customer equipment

Weight	1.0 kg
Size	143 mm
Motor size	52
Rotor surface	Rotor open, painted black
Blade material	Sheet steel, painted black
Housing material	Die-cast aluminum, painted black
Number of blades	5 截图(Alt + A)
Airflow direction	V
Direction of rotation	Counterclockwise, viewed toward rotor
Degree of protection	IP20
Insulation class	"B"
Moisture (F) / Environmental (H) protection class	H0+
Installation position	Any
Condensation drainage holes	None, open rotor
Mode	S1
Motor bearing	Ball bearing
Touch current according to IEC 60990 (measuring circuit Fig. 4, TN system)	< 0.75 mA
Electrical hookup	Plug
Motor protection	Thermal overload protector (TOP) internally connected
Protection class	I (if protective earth is connected by customer to the housing's connection point)
Motor capacitor according to EN 60252-1 in safety protection class	S0

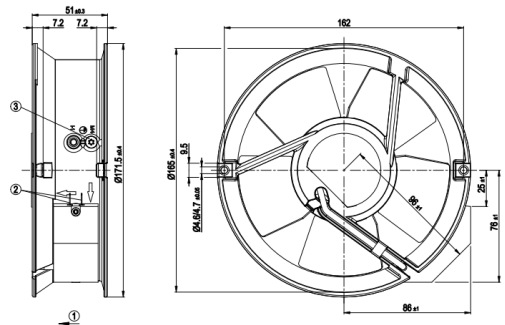

All dimensions in mm

1	Airflow direction "V"
2	2x Flat plug 2.8 x 0.5
3	M4 screw for fastening ground connector

